

TUSCAN STAIR RAILING

INSTALLATION INSTRUCTIONS

See reverse for instruction illustrations



TUSCAN
MANUFACTURING

Kit Includes:

- 2 Top/Bottom Rails*
- Balusters (12-6' • 17-8')
- 4 Stair Mounting Brackets
- 8 Mounting Screws w/plugs (#10 x 4" SS)

*aluminum inserts included w/ vinyl kits



Step 1 Safety Precautions

Review all local building codes.
Wear proper safety equipment.

Step 2 Prepare Mounting Surfaces

Level all posts or other mounting surfaces. Make certain all surfaces are secure.
Install trim rings and post sleeves.

Step 3 Mark & Cut Bottom Rail

Slide a stair bracket onto each end of the bottom rail with the bracket screw holes facing towards center of rail. Rest the bottom rail, with baluster holes facing upward, on the stair tread nose with the brackets positioned immediately adjacent to inside face of post. Position the rail and the stair brackets so the distance between the outermost baluster holes are at the maximum and equal distance from the post mounting face. The stair bracket should be positioned in such a way that when the miter cut is applied to the bracket and rail, the shortest side of the bracket is 1 1/4" to 1 1/2" in length. With a pencil, mark both bracket positions on the rail to ensure the brackets stay in position on the rail during the cutting operation. Mark the angle where the rails intersect the post by using the post mounting face as a guide to transfer the angle onto both rail brackets using a pencil.

Keep stair brackets in position on the rail using the previously established reference mark. With a power miter box or hacksaw; cut the bracket and rail simultaneously along the angled mark on the bracket. Ensure the shortest side of the bracket is NOT LESS THAN 1 1/4" IN LENGTH to ensure positive engagement of the rail under load. (Use a medium to high tooth count carbide tip blade.)

Step 4 Install Bottom Rail

With bottom rail and brackets cut to length at the proper angle, set the rail into place between the mounting surfaces and position bottom rail at the desired height above the stair tread nose equally at both top and bottom treads. (Consult your local codes to ensure the triangular opening created between the tread, riser, and rail bottom does not exceed the allowable dimensions, usually the 6" sphere rule applies.)

Ensure brackets are centered on mounting surface. Install mounting screws through brackets into the mounting surface. Install screw caps into each bracket

Step 5 Mark & Cut Top Rail

Insert balusters into the outermost machined holes of bottom rail. Slide a stair bracket onto each end of the top rail with the bracket screw holes towards the center of the rail. Insert the top of the two balusters standing from the bottom rail into the corresponding holes of the top rail. Using the same technique described in Step 3, align and mark top rail and brackets ensuring the two installed balusters remain level.

Keep stair brackets in position on the rail using the previously established reference mark. With a power miter box or hacksaw; cut the bracket and rail simultaneously along the angled mark on the bracket. Ensure the shortest side of the bracket is NOT LESS THAN 1 1/4" IN LENGTH to ensure positive engagement of the rail under load. (Use a medium to high tooth count carbide tip blade.)

Step 6 Install Balusters & Top Rail

Place balusters into each hole in the bottom rail. Move the top rail with stair brackets into place between the mounting surfaces close to the desired finished height. Beginning at one end of the top rail, insert balusters into corresponding holes in top rail.

Ensure brackets are centered on mounting surface. Install mounting screws through brackets into the mounting surface. Install screw caps into each bracket

Step 7 Trim Posts & Install Caps

Trim post sleeves to proper height and install post caps using PVC cement or silicone adhesive.

TUSCAN STAIR RAILING



TUSCAN
MANUFACTURING

INSTRUCTION ILLUSTRATIONS

See reverse for detailed written instructions

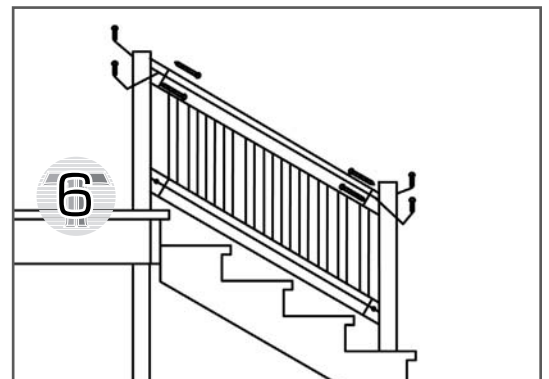
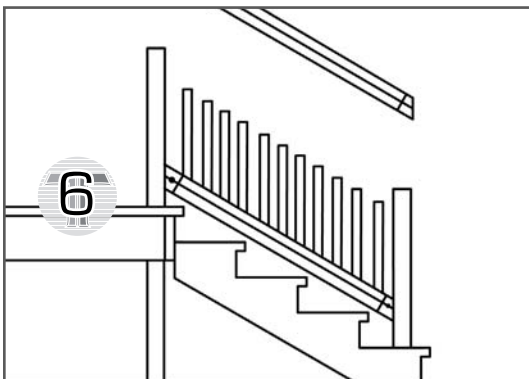
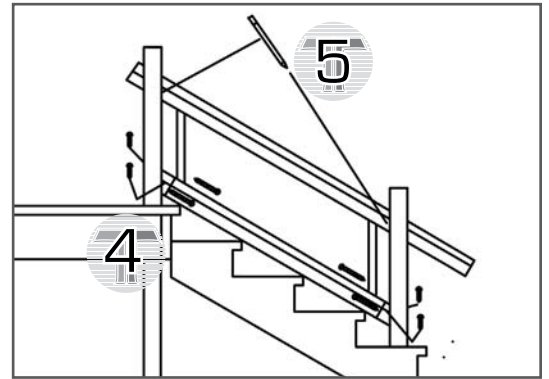
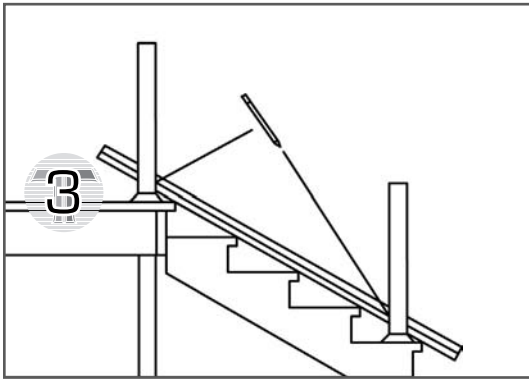
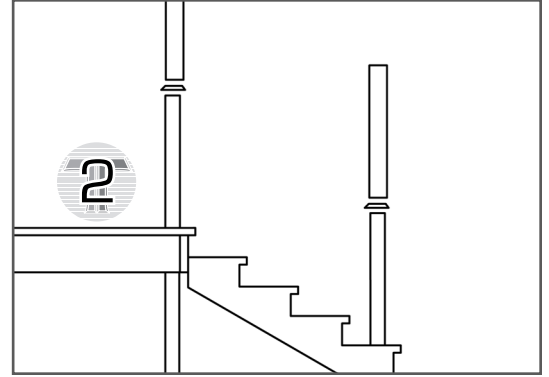
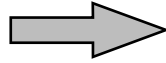
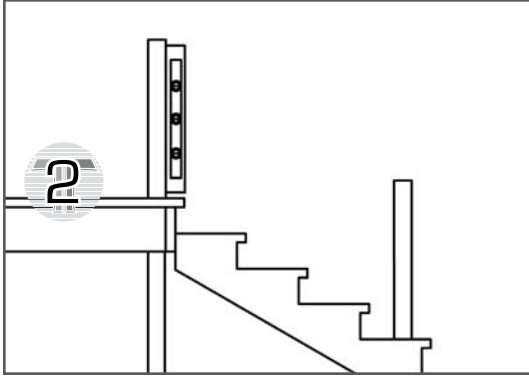

TUSCAN
MANUFACTURING